

Parafon® Decibel Barrier

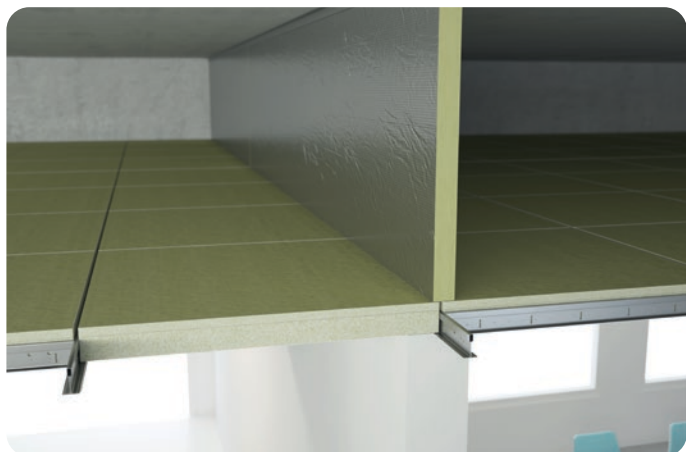

Parafon Decibel Barrier is installed vertically in the plenum above the partitioning wall and reinforces effectively the sound insulation via the suspended ceiling. Can be used as a single or double in combination with Parafon Decibel sound insulating suspended ceilings. Decibel Barrier is manufactured in non-combustible stone wool and has an aluminium layer on the front and glass-fibre felt on the back, the product is not visible after installation.

Product Description

Facing material: Aluminium foil on front side, glass fiber tissue on back side.

Treatment of edges: Untreated

Edges & Dimensions

Thickness	Width x Length (modular size)	Weight kg/m ²
40	1200 x 900 mm	4,8

Performances

Reaction to fire



A1

According to: EN 13964:2014 (EN 13501-1)

Fire resistance



The fire performance of mineral wool does not deteriorate with time. The Euroclass classification of products is related to the organic content, which cannot increase with time.

Cleaning



May be cleaned using a soft brush, by vacuum cleaning or by wiping with a damp cloth or sponge.

Humidity and sag resistance



May be used continuously in 95% relative humidity at a temperature of 30 °C, occasionally also at 100% and 40 °C.

Indoor environment



M1, Danish Indoor Climate Labelling class 2.



Environment & sustainability



Fully recyclable stone wool

Installation



Install vertically above the partition wall. All gaps and joints will be clogged and then sealed with air tight tape.

Direct sound insulation



$R_w = 21$ dB

According to: SS-EN ISO 10140 / SS-EN ISO 717-1

R_w Decibel Barrier 2x40mm = 36 dB

Room to room sound insulation



$D_{n,f,w} = -$ dB

According to: SS-EN ISO 10848 / SS-EN ISO 717-1

$D_{n,f,w}$ with a single Decibel Barrier R_w 21 dB:

Parafon Decibel Light, 40mm: 48* dB

Parafon Decibel Mute, 55mm: 52/52* dB

Parafon Decibel Mass, 53mm: 52* dB

Parafon Exclusive, edge D2, 25mm: 40* dB

Any Parafon sound absorber, edge A, 15/18mm: 30* dB

Any Parafon sound absorber, edge A, 40mm: 38* dB

$D_{n,f,w}$ with double Decibel Barrier panels R_w 36 dB:

Parafon Decibel Light, 40mm: 53* dB

Parafon Decibel Mute, 55mm: 54/56* dB

Parafon Decibel Mass, 53mm: 54* dB

Parafon Exclusive, edge D2, 25mm: 48* dB

Any Parafon sound absorber, edge A, 15/18mm: 40* dB

Any Parafon sound absorber, edge A, 40mm: 46* dB

The values are measured and/or calculated with a continuous ceiling. Sound insulation values apply to edge A unless otherwise stated.

*Estimated values.

Parafon® is a registered trademark
of the ROCKWOOL Group.



[Linkedin.com/Parafon](https://www.linkedin.com/company/parafon)



[Youtube.com/Parafon](https://www.youtube.com/channel/UCv3v3v3v3v3v3v3v3v3v3v3)

www.parafon.com

03.2023 | All colour codes mentioned are based on the NCS - Natural Colour System® property of
and used on license from NCS Colour AB, Stockholm 2012
or the RAL colour standard. Subject to alterations in range and product technology without prior
notice. Parafon accepts no responsibility for printing errors.

Parafon
(ROCKWOOL AB)

Reception:
Lillebovägen 2
541 91 Skövde

Delivery address:
Rydsdalsvägen 9
541 91 Skövde

E-mail: order@parafon.com
Tel.: +46 (0)500-10 11 00

